



MACRON DYNAMICS, INC.

PRODUCT
Datasheet

SPECIFICATIONS

Bearing block replacement kit

Assembly

BBK-14M

Shipping Weight	4.3 lbs
Actuator Type	Macron 14 Linear Actuator
Maximum Speed	400 in/sec
Acceleration Exceeding	9 G's

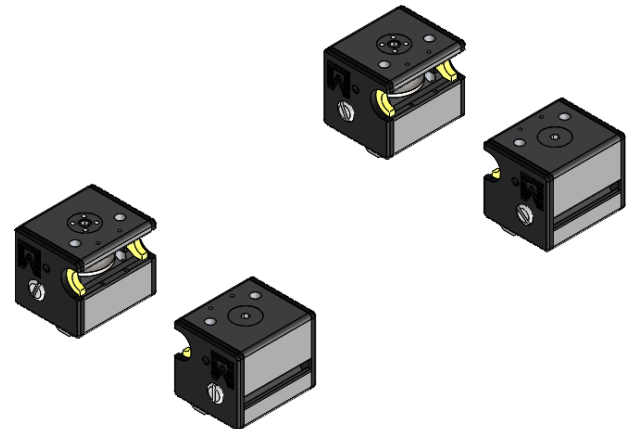

MATERIALS

Bearing Block Housing	Aluminum
Rollers	Steel
Screws	Steel/Nylon

PARTS BREAKDOWN

DESCRIPTION	QTY
Bearing Block Housing	4
RLK-14S (See page 2)	1
WRK-14S (See page 2)	2
Hardware (P/N 048)	8

DIMENSIONS

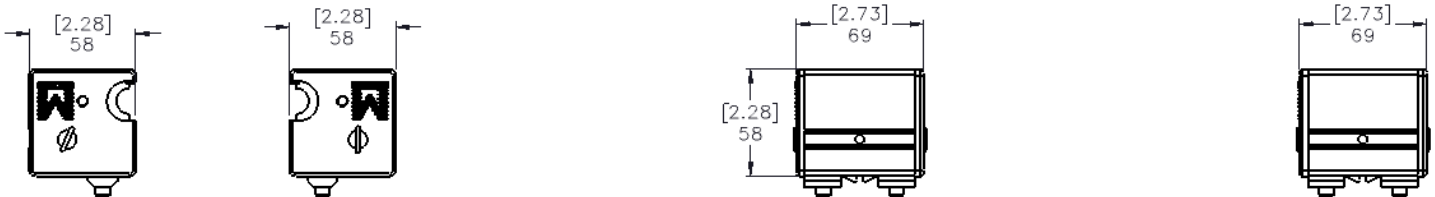

MACRON DYNAMICS, INC.
100 Phyllis Drive
Croydon, PA 19021

P: 215-443-8888
F: 215-443-0981
macron@macrondynamics.com

www.macrondynamics.com

Rev 01



PARTS BREAKDOWN

Description	QTY
14 CONCENTRIC ROLLER SHAFT	2
14 ECCENTRIC ROLLER SHAFT	2
14 ROLLER	4
14 SPANNER NUT	2
14 SHAFT SPACER	4

**ROLLER
REPLACEMENT KIT
RLK-14S**

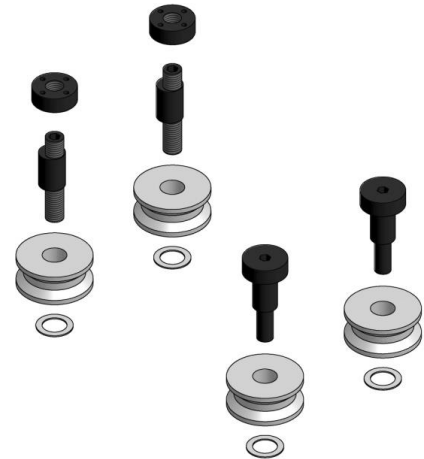

PARTS BREAKDOWN

Description	QTY
14 WIPER	4
14 WIPER SPRING	4
M8 Pan Head Screw	4
14 LUB. END CAP, LEFT	2
14 LUB. END CAP, RIGHT	2

**WIPER
REPLACEMENT KIT
WRK-14S**

