



## SPECIFICATIONS

## Bearing block replacement kit

### Assembly

Shipping Weight	20 lbs
Actuator Type	Macron 14H Linear Actuator
Maximum Speed	400 in/sec
Acceleration Exceeding	9 G's

### BBK-14C

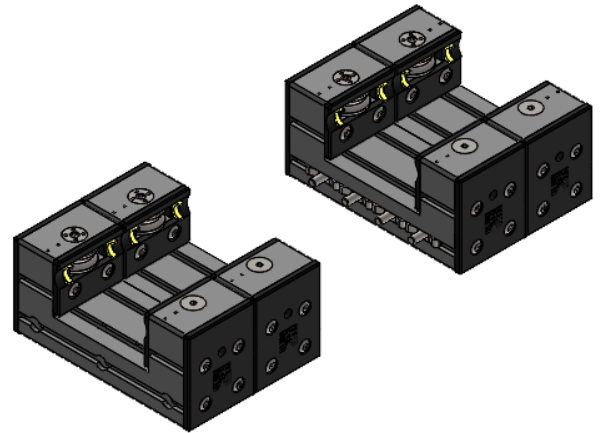

## MATERIALS

Bearing Block Housing	Aluminum
Rollers	Steel
Hardware	Steel

## PARTS BREAKDOWN

DESCRIPTION	QTY
Bearing Block Housing	4
RLK-14S (See page 2)	2
WRK-14H (See page 2)	2
M8x35 SHCS-ZP	6
M8 HD T-nut	6
Standard Fastener Set	8

## DIMENSIONS

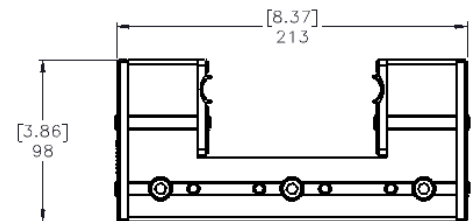
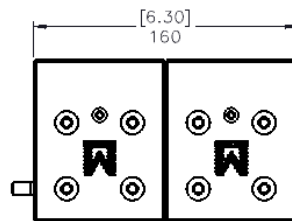
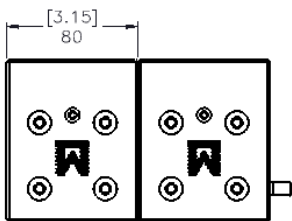



# MACRON DYNAMICS, INC.

PRODUCT  
Datasheet

## ROLLER REPLACEMENT KIT RLK-14S

### PARTS BREAKDOWN

Description	QTY
14 CONCENTRIC ROLLER SHAFT	2
14 ECCENTRIC ROLLER SHAFT	2
14 ROLLER	4
14 SPANNER NUT	2
14 SHAFT SPACER	4

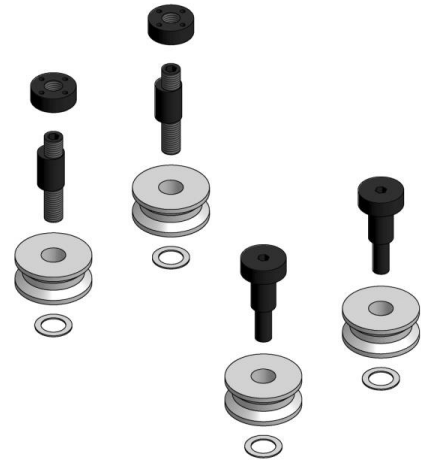

## WIPER REPLACEMENT KIT WRK-14H

### PARTS BREAKDOWN

Description	QTY
LUBRICATING END CAP	4
SPRING	8
WIPER	8
M8x10 BHCS-ZP	8
M8x25 BHCS-ZP	8

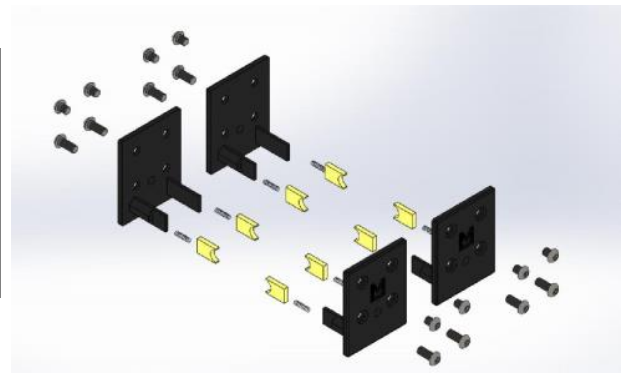

MACRON DYNAMICS, INC.  
100 Phyllis Drive  
Croydon, PA 19021

P: 215-443-8888  
F: 215-443-0981  
macron@macrondynamics.com

[www.macrondynamics.com](http://www.macrondynamics.com)

Rev 01



**BEARING BLOCK BREAKDOWN**

