

NOTE: MOUNTING FLANGE THICKNESS MAY VARY BASED ON MOTOR SHAFT LENGTH  
 MINIMUM THICKNESS IS 23.5mm FOR SHAFTS UP TO 31mm IN LENGTH.  
 ANY MOTOR SHAFT LONGER THAN 31mm WILL ELONGATE THE ADAPTER  
 BY ABOUT THE SAME AMOUNT THAT THE SHAFT IS LONGER.

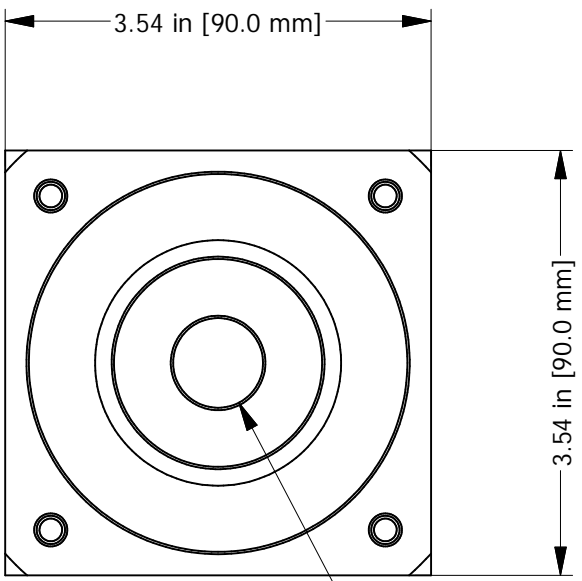

MAX MOTOR SHAFT  $\phi$  =  
 $\phi$ .75 in [19.0 mm]

MOTOR  
 INTERFACE  
 PLATE

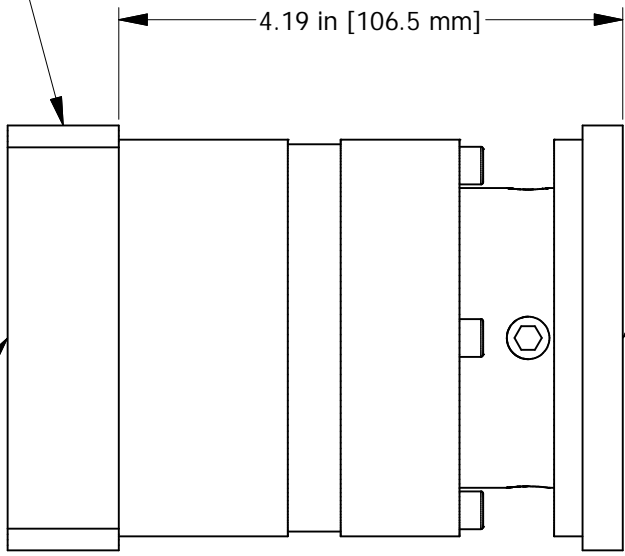

ACTUATOR  
 INTERFACE  
 PLATE

 3RD ANGLE PROJECTION	<small>THIS DRAWING IS THE PROPERTY OF MACRON DYNAMICS. ANY REPRODUCTIONS SHALL BE FOR QUOTATION, MANUFACTURING, OR PURCHASING PURPOSES ONLY. RELEASE OF DRAWINGS TO OTHER CONCERNS DOES NOT CONSTITUTE LICENSING. IN ANY WAY, INFORMATION CONTAINED HEREIN IS PROPRIETARY AND CONFIDENTIAL.</small>		 MACRON DYNAMICS, INC.
	COMPUTER GENERATED DOCUMENT. MANUAL CHANGES NOT PERMITTED.		
STD. RAW STOCK COMER'L. TOL. APPLY BREAK ALL UNNECESSARY SHARP EDGES DIMENSIONAL LIMITS APPLY AFTER FINISH UNLESS OTHERWISE SPECIFIED ALL DIMENSIONS IN INCHES ALL DIMENSIONS IN [ ] ARE IN MILLIMETERS -TOLERANCES UNLESS SPECIFIED- ANGULAR 0°-30° FRACTIONAL $\pm$ 1/64 [0.40] DECIMAL 2 PLC $\pm$ 0.01 [0.25] DECIMAL 3 PLC $\pm$ 0.005 [0.13]	SCALE NONE	DATE 7/3/2007	ORDER #
DRAWN Larry	CHECKED KM	APPROVED LM	TITLE 082 GEAR BOX
TOP LEVEL ASSEMBLY	SIZE C	DWG. NO. MPG-082	REV 00
	DO NOT SCALE DRAWING		SHEET 1 OF 1